

DCHOUSE™ Solar Vent Fan

Fully automatic operation powered by free solar energy.

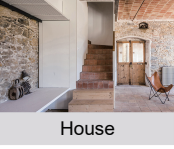

House



Factory

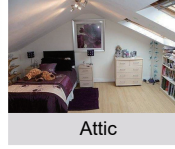

Attic



Basement



Cabin



Greenhouse

Specification

DC Fan	
Motor Life Span	More than 1000h
Motor Power	0.05W 5V
Bearings	Brushless Bearings
Blades Material	High Quality PVC
Shell Material	Galvanized Steel
Length * Width	9.45*9.45in(240*240mm)
Height	3.15in(80mm)

Solar Panel	
Irradiance and Cell Temperature	1000W/m ² AM1.5 25°C
Max Power (P)	5W
Max Power Voltage (Vpm)	5V
Max power Current (Ipm)	0.01A
Length * Width	9.33*9.33in (237*237mm)
Height	0.12in (3mm)

DCHOUSE™ Solar Vent Fan

Fully automatic operation powered by free solar energy.



Tools and Materials Required



Impact drill

(for opening holes)



Screwdriver



Wire stripper



Compasses

(determine the size of the wall opening)



Ruler



Some M4 Screws



Glue

(seal the gap after installation)

Installation Preparation

1. This solar fan is a perfect cooling and ventilation solution for any space at your home, including the attics, roofs, garages, sheds, green houses, doghouse, RV and more. You can choose the installation place according to your needs.

2. Use a compass or ruler to measure the size of the solar fan, then fix it to the wall with a compass or ruler, turn out the size of the mounting hole we need, and then use an assault drill or an electric hammer to drill the required hole.

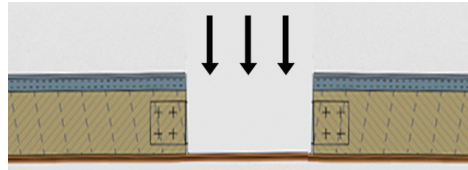

3. Install the solar fan into the hole, use a screwdriver to screw on the corresponding screws, and seal the gap between the exhaust fan and the wall with glue.

WARRANTIES

Limited 365 Day Warranty (Retail)

DCHOUSE makes every effort to assure that its products meet high quality and durability standards, and warrants to the original purchaser that this product is free from defects in materials and workmanship for the period of 365 days from the date of purchase.

This warranty does not apply to damage due directly or indirectly, to misuse, abuse, negligence or accidents, repairs or alterations outside our facilities, criminal activity, improper installation, normal wear and tear, or to lack of maintenance.

Proof of purchase date and an explanation of the complaint must accompany the merchandise. If our inspection verifies the defect, we will either repair or replace the product at our election or we may elect to refund the purchase price if we cannot readily and quickly provide you with a replacement. We will return repaired products at our expense, but if we determine there is no defect, or that the defect resulted from causes not within the scope of our warranty, then you must bear the cost of returning the product.

Call: 1-866-939-8222

Email: DCHOUSE_GLOBAL@163.com